

FOR ENQUIRIES PLEASE CALL
欲知更多详情，欢迎来电：

012-340 1988
017-960 2988



Developer 发展商
Wira Cheras Development Sdn Bhd (557483-U)
No. 5, Jalan Indah 2/7, Taman Indah,
43200 Batu 11 Cheras, Selangor Darul Ehsan
Tel: 03-9075 5333 (Hunting Line)
Fax: 03-9076 5533

Exclusive Marketing Agent 独家销售代理
ROYALE RICH 皇家富豪
Real Estate Agent

All plans, information and specification contained herein are subject to change without notification as may be requested by the relevant authorities or the Developer's consultants and cannot form part of an offer or contract. All illustrations and pictures are artist impressions only. While every reasonable care has been taken in providing this information, the Developer cannot be held liable for any errors or misrepresentation or changes. The items are subject to variations, modifications and substitutions as may be recommended by the Company's consultants and / or relevant approving authorities.

**NILAI
UTAMA**
INDUSTRIAL PARK 工业园

**NILAI
UTAMA**

INDUSTRIAL PARK 工业园

FREEHOLD
永久地契

CORPORATE OFFICE 企业办公楼 | SHOWROOM 展示室 | FACTORY 厂房 | WAREHOUSE 仓库



**A DYNAMIC
INDUSTRIAL ADDRESS** 与时俱进的工业要址



Within the developed and established industrial zone of Nilai, the Nilai Utama Industrial Park is envisioned to be a modern and perceptive facility.

Units are designed with flexibility & functionality in mind and for a wide spectrum of industrial businesses.

Nilai Utama 工业园坐落于发展完善成熟的汝来工业区境内，预期成为一所具前瞻性的现代化生产要地。

各个单位均精心规划，以创造变通性和实用价值作为设计构想，迎合各类工商业的需求。

MODERN DOUBLE STOREY SEMI-D FACILITY 现代化双层半独立型设施

THE PERFECT 10 完美10项

- HIGH POWER SUPPLY - 3 PHASE 200 AMP**
高电力供应 - 3 相式 200 AMP 电流
- LARGE BUILT UP: FROM 10,128 SQ FT**
建筑面积特大: 由 10,128 平方尺起
- PRACTICAL & FUNCTIONAL LAYOUT**
功能实用的布局
- ALARM SYSTEM WITH CCTV**
闭路电视及警报系统
- ELECTRIC ROLLER SHUTTER**
厂房设有电动卷帘
- AUTOGATE WITH SYSTEM INSTALLATION**
自动门系统



7 30 FEET CEILING HEIGHT FOR PRODUCTION AREA
生产房具备30尺高天花

8 WIDE EXIT AND ENTRYWAYS
宽敞的出入通道

9 MODERN CORPORATE FACADE
现代感企业外观形象

10 AMPLE CAR PARKS & LOADING SPACE
大量泊车位及卸货空间



10
EXCLUSIVE
UNITS
10个专属单位

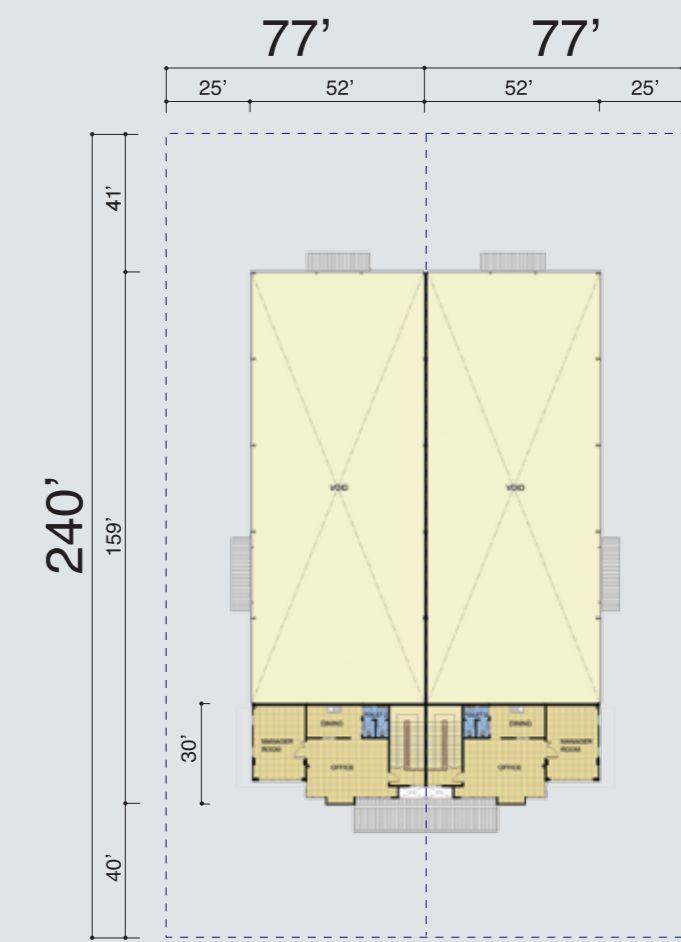

FIRST FLOOR 一楼



GROUND FLOOR 底层

SPECIFICATIONS

STRUCTURE	
Foundation	Reinforced Concrete Footings
Framework - Office	Reinforced Concrete Frame
- Factory	Metal Frame
BRICKS	
Walls	Bricks with Cement Plastering
ROOF	Metal Roofing Sheet with Insulator
ROOF STRUCTURE	Metal Construction
CEILING	
Ground & First Floor	
Office	Skim Coat / Suspended Ceiling
WINDOWS	
Ground & First Floor	
Factory, Entrance, Office, Manager's Room & Dining	Aluminium Frame / Glass Window
Toilet	Aluminium Frame Top Hung Window
DOORS	
Ground & First Floor	
Manager's Room & Toilet	Plywood Flush Door
Office	1 Hour Fire Rated Door / Aluminium Frame Swing Door
Factory	M.S. Roller Shutter
LOCKS	
Factory, Office & Toilet	Quality Cylindrical Lockset
FLOORING	
Factory, Office, Dining, Toilet & Staircase	Ceramic Tiles
Factory	Power Floated
WALL TILES	
Toilet	7' 0" High Ceramic Tiles
SANITARY FITTINGS	
Aluminium Sink	1 No.
Sitting WC	4 Nos.
Washbasin	4 Nos.
ELECTRICAL INSTALLATION	
Lighting Point	39 Nos.
Emergency Light	15 Nos.
'Keluar' Sign	6 Nos.
13 amp Plug Point	15 Nos.
Telephone Point	4 Nos.

TYPICAL UNIT 典型单位
77' x 240'

LOT SIZE 土地面积
from **18,485 sq ft**

BUILT UP 建筑面积
10,128 sq ft